

## KDE-1137M-60 Diesel Generator Set

Powered by 

### General Features

- Engine (CCEC Cummins NTA855-G1), Radiator ● Engine (MTU 16V2000G45), Radiator 40°C max, belt driven fans, with safety guard
- 24V charge alternator
- Alternator (Stamford, Leroy Somer & Mecc Alte for option), single bearing alternator IP23, insulation class H/H
- Skid and vibration isolators
- Dry type air filter, fuel filter, oil filter
- Main line circuit breaker
- Standard control panel
- Four 12V batteries, rack and cable
- Ripple flex exhaust pipe, exhaust siphon, flange, industrial muffler

PHOTO FOR REFERENCE ONLY



### Technical Data

Output Frequency	60 Hz
Rated Speed	1800RPM
Prime Power	1025KVA/820K
Standby Power	W
Rated Voltage	1137KVA/910K
Phase	W
Power Factor	440/254V
Fuel Consumption 100% Load	3
Fuel Consumption 75% Load	0.8
Fuel Consumption 50% Load	206g/Kwh
Operation Altitude	210g/Kwh
Ambient Temperature	215g/Kwh
	≤1000m



### Dimension and Weight

Genset Type	Open Frame	Soundproof Containerized
Length(L) (mm)	4450	ISO 20ft GP
Width(W) (mm)	1600	ISO 20ft GP
Height(H) (mm)	2315	ISO 20ft GP
Gross Weight (kg)	7850	12000

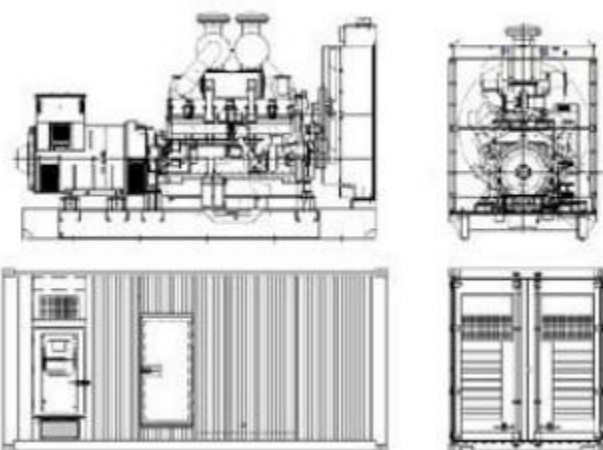

# KDE-1137M-60 Diesel Generator Set

Powered by



## Engine Specification

Manufacturer / Model:	MTU 16V2000G45
Air Intake System:	Turbo, Air/Air Cooling
Fuel System:	Electronic Fuel Injection System
Cylinder Arrangement:	16 in V
Displacement:	31.84L
Bore and Stroke:	130*150 (mm)
Compression Ratio:	16:1
Rated RPM:	1800rpm
Max. Standby Power at Rated RPM:	1007KW without fan
Governor Type:	ADEC
Exhaust Gas Flow:	192m <sup>3</sup> /min
Exhaust Temperature:	520°C
Max Back Pressure:	8.5kPa
Max Intake Restriction:	5kPa
Burning Capacity:	81m <sup>3</sup> /min
Intake Flow:	1476m <sup>3</sup> /min
Total Oil Capacity:	102L
Oil Consumption:	0.5% Fuel Consumption
Total Coolant Capacity:	200L
Max Water Temperature:	102°C

## Alternator Specification

Manufacturer / Model:	STAMFORD S6L1D-D4
Number of Phase:	3
Connecting Type:	3 Phase and 4 Wires, "Y" type connecting
Number of Bearing:	1
Protection Grade:	IP23
Exciter Type:	Brushless, self-exciting
Insulation Class, Temperature Rise:	H/H
Telephone Interference Factor (TIF):	< 50
THF:	< 2%
Voltage Regulation, Steady State:	≤ ± 1%
Alternator Capacity:	1063KVA
Alternator Efficiencies:	95.1%
Air Cooling Flow:	1.71m <sup>3</sup> /s

## KDE-1137M-60

## Diesel Generator Set

Powered by



### Control System

#### Standard Deepsea DSE6020 Auto Mains Failure Control Panel

- Manual or Auto Start Module for single genset applications. Designed to work with electronic and non-electronic engines, providing advanced engine monitoring and protection features.
- Includes a back-lit LCD display which shows the status of the engine at all times. Monitors engine speed, frequency, voltage and run hours and also displays the warning and shutdown status.
- Includes extensive outputs and inputs making this product ideal for a wide variety of applications. It can either be programmed using the front panel or by using DSEPC software.



#### Optional Deepsea DSE7320 Auto Mains Failure Control Panel

- Auto Mains (Utility) Failure Control Module suitable for a wide variety of single genset applications.
- Displays warnings, shutdown and engine status info on the back-lit LCD screen, illuminated LEDs, remote PC. Monitors the mains (utility) supply. Includes USB, RS232 and RS485 ports for system expansion.
- Compatible with electronic and non-electronic engines and offers flexible inputs, outputs and engine protections to meet extensive industry requirements.
- Includes enhanced event and performance monitoring, remote communication to reduce engine wear. It can either be programmed using the front panel or by using DSEPC software.



#### Optional Deepsea DSE8610 Auto Paralleling Control Panel

- Synchronizing Auto Start Control Module for multi-genset loadshare system, designed to synchronize up to 32 gensets including electronic and non-electronic engines.
- Monitors the genset and indicates operational status and fault conditions, automatically starting or stopping the engine on load demand or fault condition.
- System alarms are annunciated on the LCD screen, illuminated LED and audible sounder.
- Records 250 events log for maintenance. Extensive monitoring, metering and protection features are included as well as comprehensive communication and system expansion options.
- Using DSE PC Software allows alteration of the operational sequences, timers, alarms with all communication ports active.



# KDE-1137M-60 Diesel Generator Set

Powered by



## Optional

### Engine

- Water Jacket Preheater
- Water Separator
- Oil Pump
- Oil Preheater
- Battery Charger

### Fuel System

- Daily Fuel Tank
- External Fuel Tank
- Auto Fuel Filling System
- Fuel Level Sensor

### Control System

- Auto Remote Control Panel
- AMF Function Control Panel
- Auto Paralleling Control Panel
- Auto Transfer Switch (ATS)
- ABB breaker

### Alternator

- Anti Condensation Heater
- Permanent Magnet Generator
- Winding Temp Sensor

### Enclosure

- Rainproof Type
- Soundproof Rental Type
- Mobile Type

### Available Voltages

- 440/254V
- 415/240V
- 380/220V

## Reference Standards

**Generator Set:** ISO 8528, CE

**Engine:** ISO 3046, BS 5514, DIN 6271

**Alternator:** BS EN 60034, IEC34, BS5000, NEMA MG1-32, VDE 0530, CSA C22.2-100, AS1359

## Warranty

KNOX Power provides a full line of brand new and high quality products. Each and every unit is strictly factory tested.

Warranty is according to our standard conditions: A. 15 months, counted on the day KNOX sold to the first buyer; B. One year after installation; C. 1000 running hours (accumulated); subject to the earlier one.

Service and spare parts are available from KNOX Power or distributors in your location.